

AUTORIZACE

ČÍSLO PARE

ČÍSLO ZMĚNY	DATUM ZMĚNY	POPIS/OBSAH ZMĚNY	PODPIS

II/353 D1 - RYTÍŘSKO - JAMNÉ, I. STAVBA, PD

název akce

SO 101 PŘELOŽKA SILNICE II/353

stavební objekt

Kraj Vysočina Žižkova 1882/57 586 01 Jihlava objednatel	spolupráce
ÚSEK SILNICE II/353 místo stavby	VYSOČINA kraj

DIK
DOPRAVNĚ INŽENÝRSKÁ KANCELÁŘ
 Bozděchova 1668, 500 02 Hradec Králové
 tel : 495 219 036, 495 212 647, fax : 495 221 677
 e-mail : dik@dik - hk.cz, http : www.dik-hk.cz

VZOROVÁ ULIČNÍ VPUST výkres	1:20 měřítko	DSP stupeň
---------------------------------------	-----------------	---------------

ING. MILOŠ BURIANEC kontroloval	<i>Miloslav Burianec</i>	ING. DAVID JANEČKA hlavní inženýr projektu	<i>David Janečka</i>	A086/21 číslo zakázky	D.1.8
ING. DAVID JANEČKA zodpovědný projektant	<i>David Janečka</i>	ING. DAVID JANEČKA zpracoval	<i>David Janečka</i>	04/2023 datum	

číslo přílohy

SKLADBA UV - VARIANTA VE ŽLABU

UV2, UV6, UV32, UV35, UV36

1:20

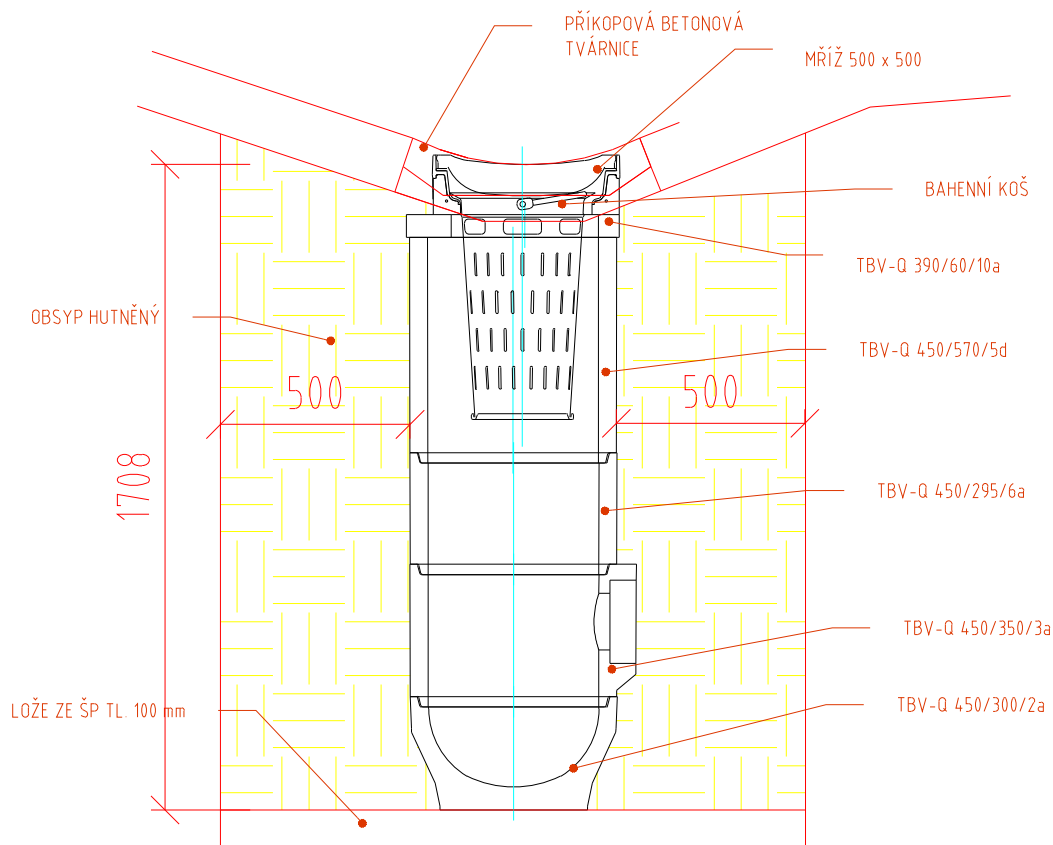

JEDNOTLIVÉ DÍLY SESTAVY

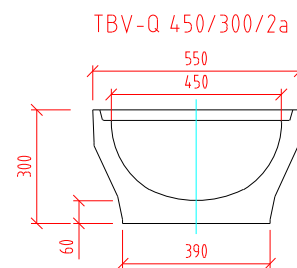
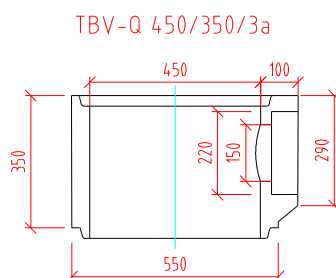
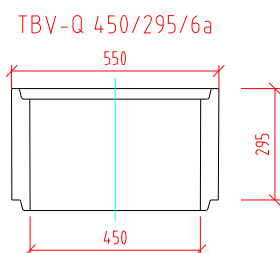
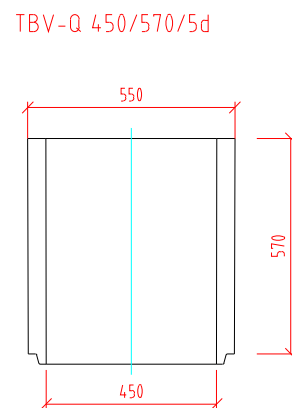
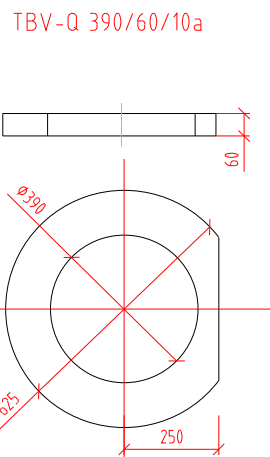
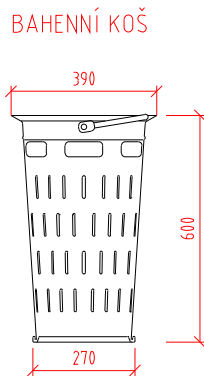
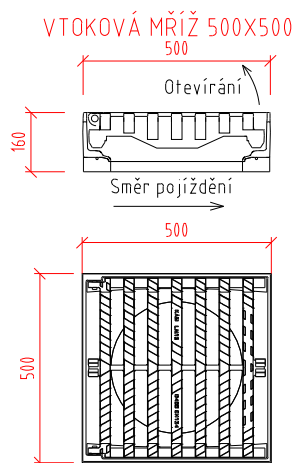

SKLADBA UV - VARIANTA VE ŽLABU - UV5 1:20

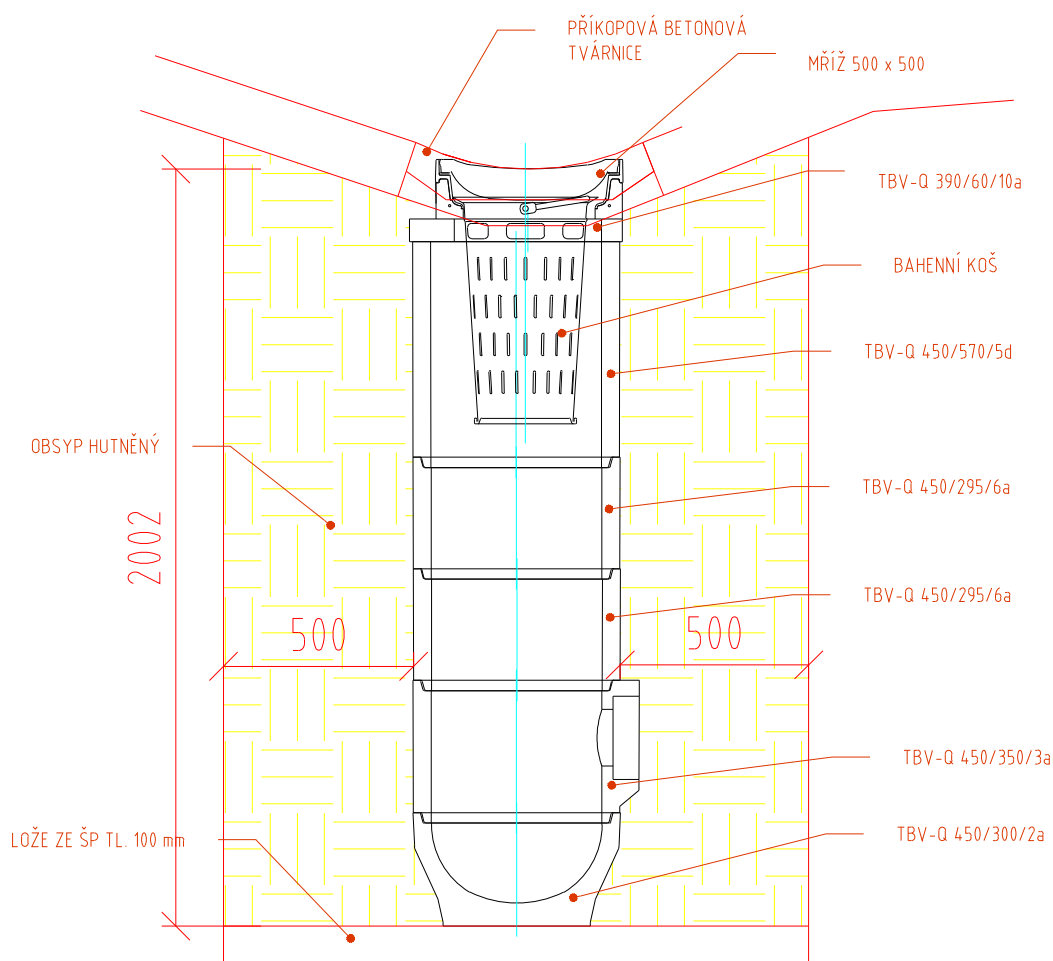

JEDNOTLIVÉ DÍLY SESTAVY

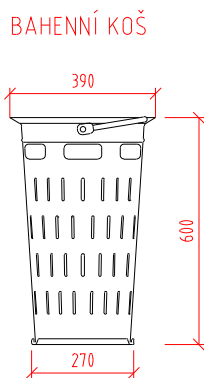
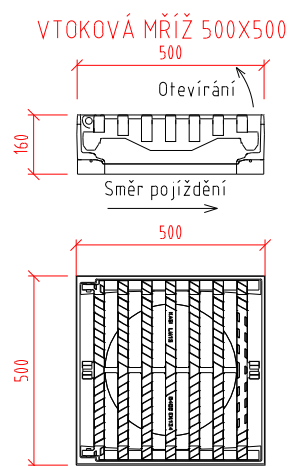

TBV-Q 390/60/10a

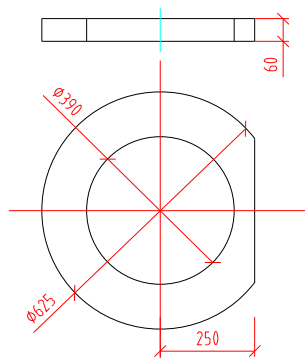

TBV-Q 450/570/5d

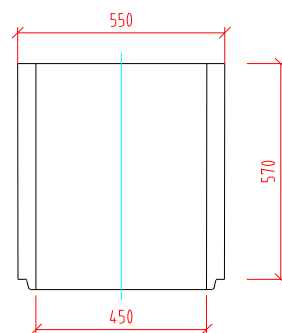

TBV-Q 450/295/6a

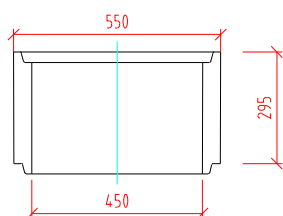

TBV-Q 450/350/3a

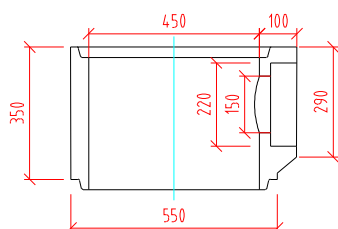

TBV-Q 450/300/2a

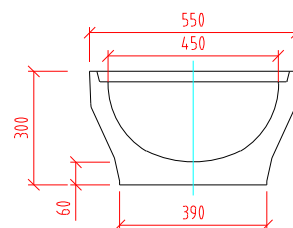

SKLADBA UV - CURB KING

UV23, UV25, UV27, UV29, UV31, UV1

1:20

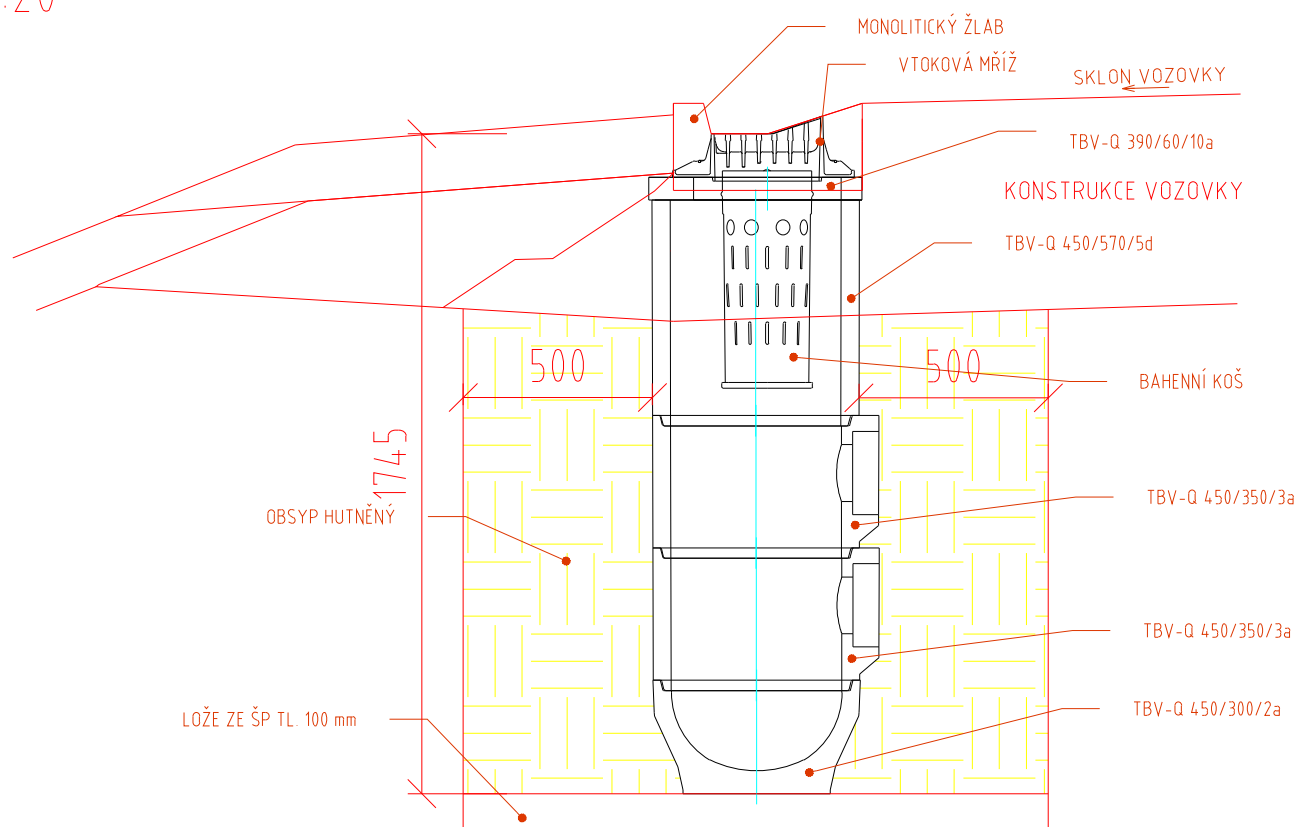

JEDNOTLIVÉ DÍLY SESTAVY

VTOKOVÁ MŘÍŽ

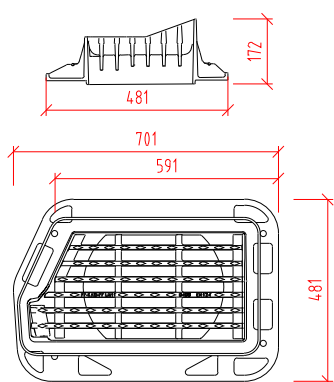

BAHENNÍ KOŠ

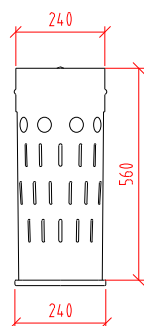

TBV-Q 390/60/10a

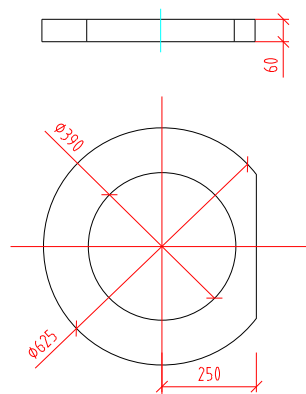

TBV-Q 450/570/5d

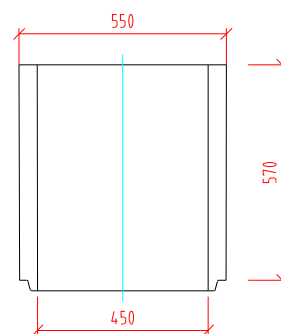

TBV-Q 450/350/3a

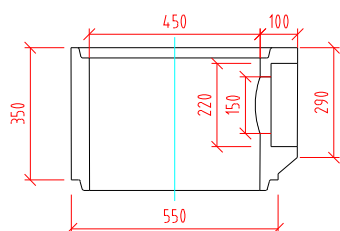

TBV-Q 450/300/2a

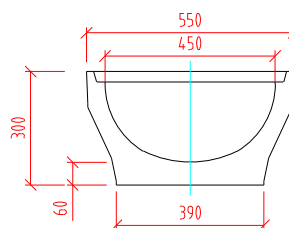

SKLADBA UV - CURB KING UV3, UV28, UV30, UV33, UV4 1:20

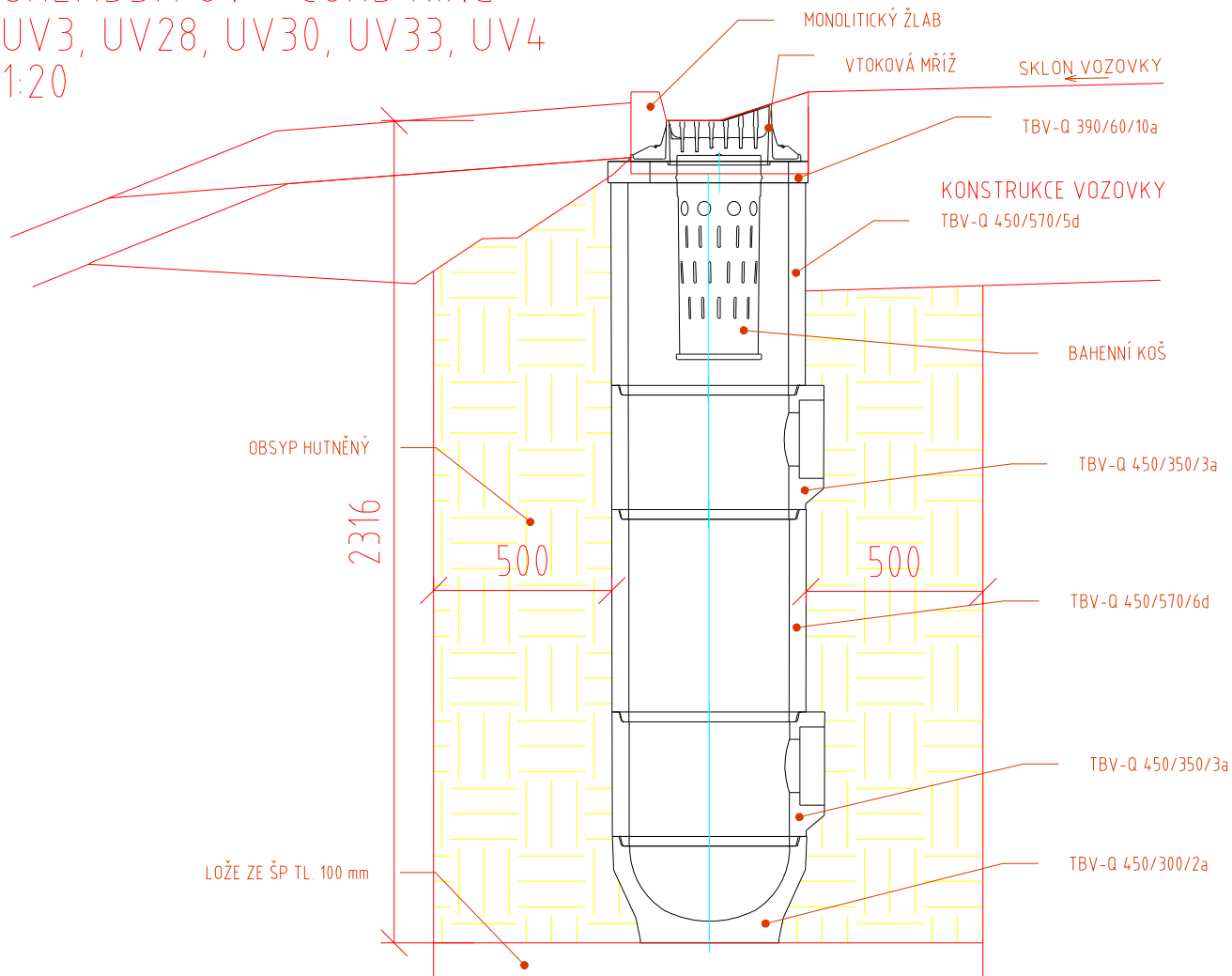

JEDNOTLIVÉ DÍLY SESTAVY

VTOKOVÁ MŘÍŽ

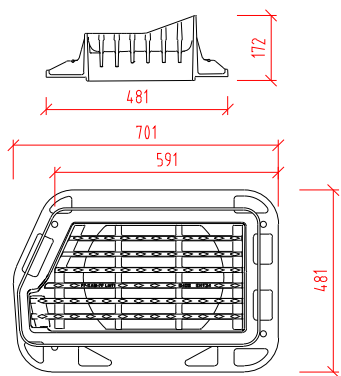

BAHENNÍ KOŠ

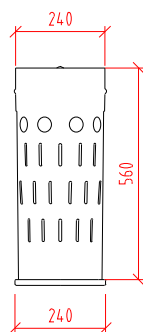

TBV-Q 390/60/10a

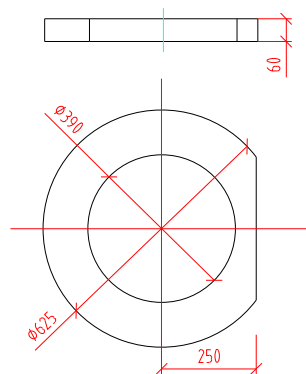

TBV-Q 450/570/5d

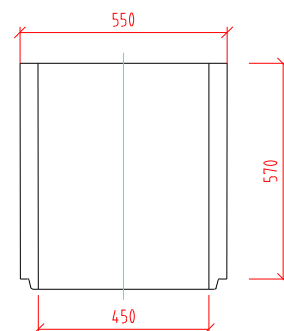

TBV-Q 450/570/6d

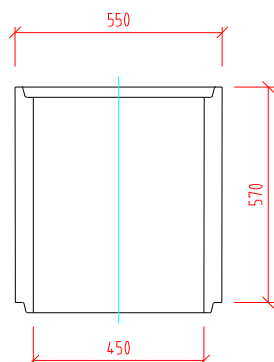

TBV-Q 450/350/3a

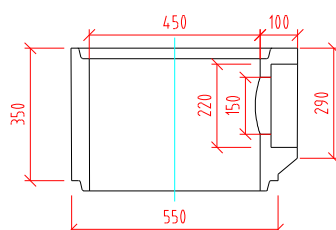

TBV-Q 450/300/2a

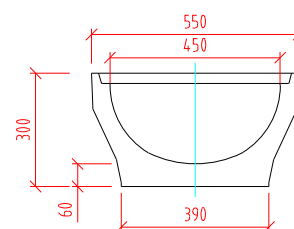

SKLADBA UV - CURB KING UV22, UV24, UV26, UV34 1:20

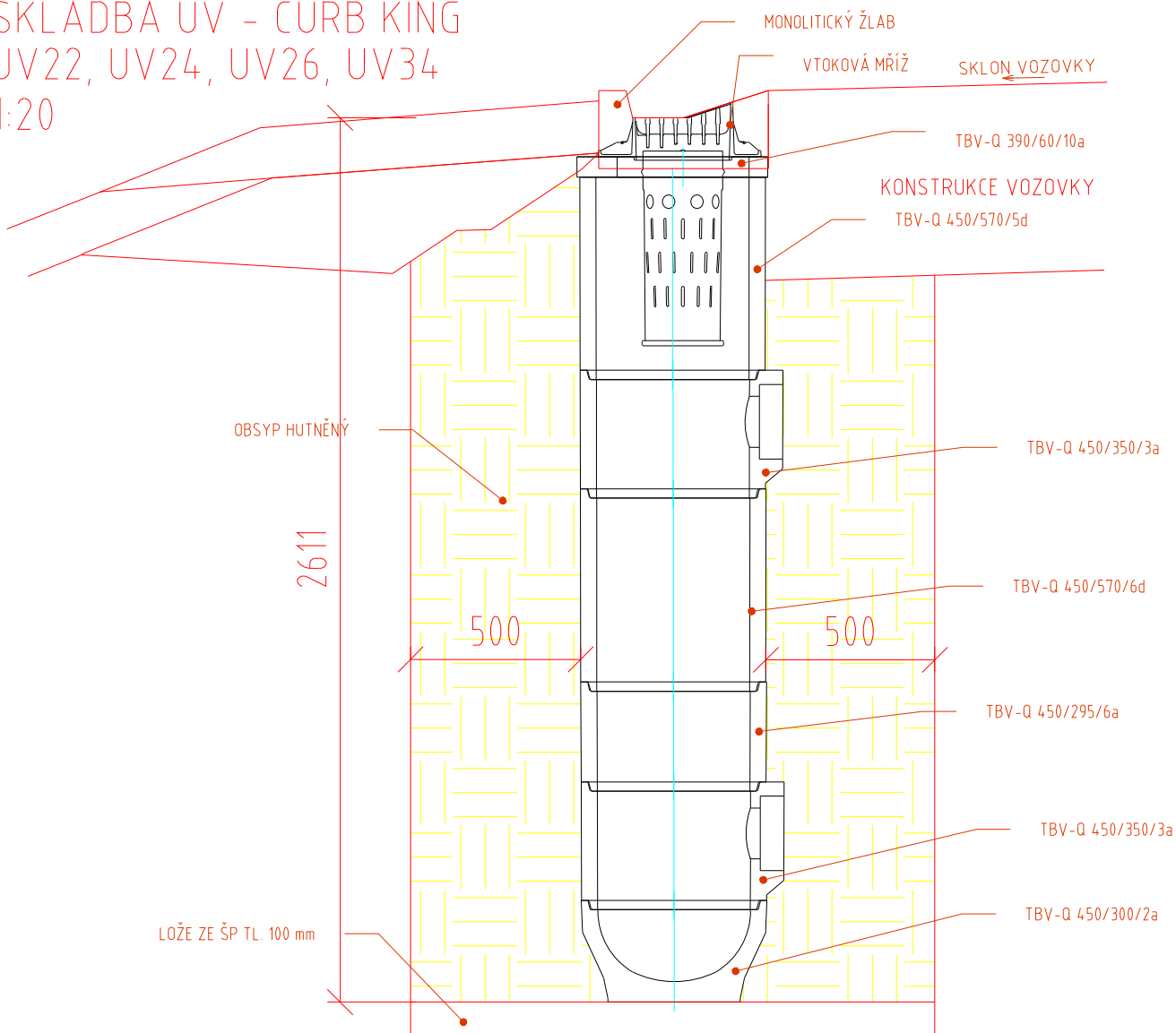

JEDNOTLIVÉ DÍLY SESTAVY

VTOKOVÁ MŘÍŽ

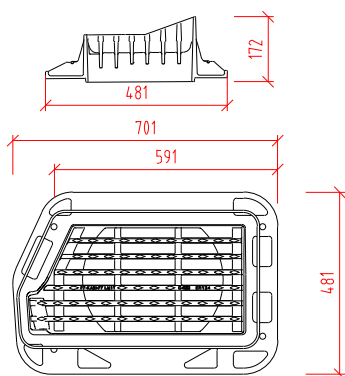

BAHENNÍ KOŠ

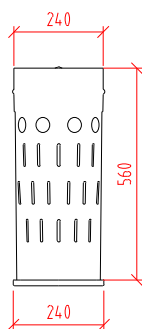

TBV-Q 390/60/10a

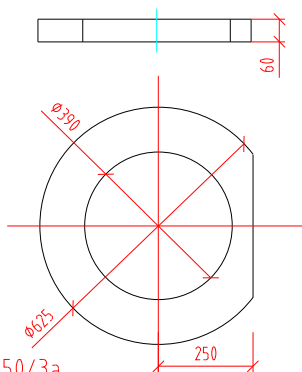

TBV-Q 450/570/5d

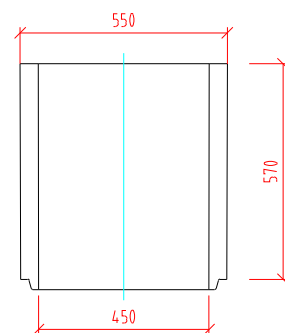

TBV-Q 450/570/6d

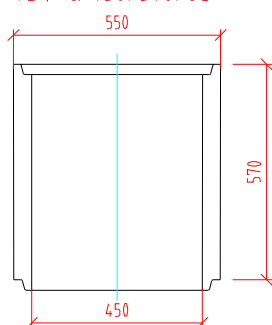

TBV-Q 450/350/3a

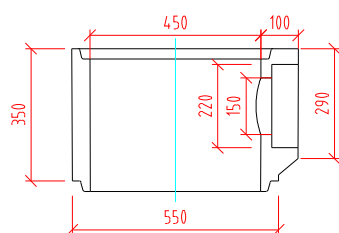

TBV-Q 450/300/2a

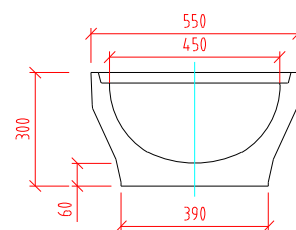

UV7, UV8, UV9, UV11, UV16, UV17, UV19, UV21, UV13

VTOKOVÁ MŘÍŽ V SAMONIVELAČNÍM RÁMU

1:20

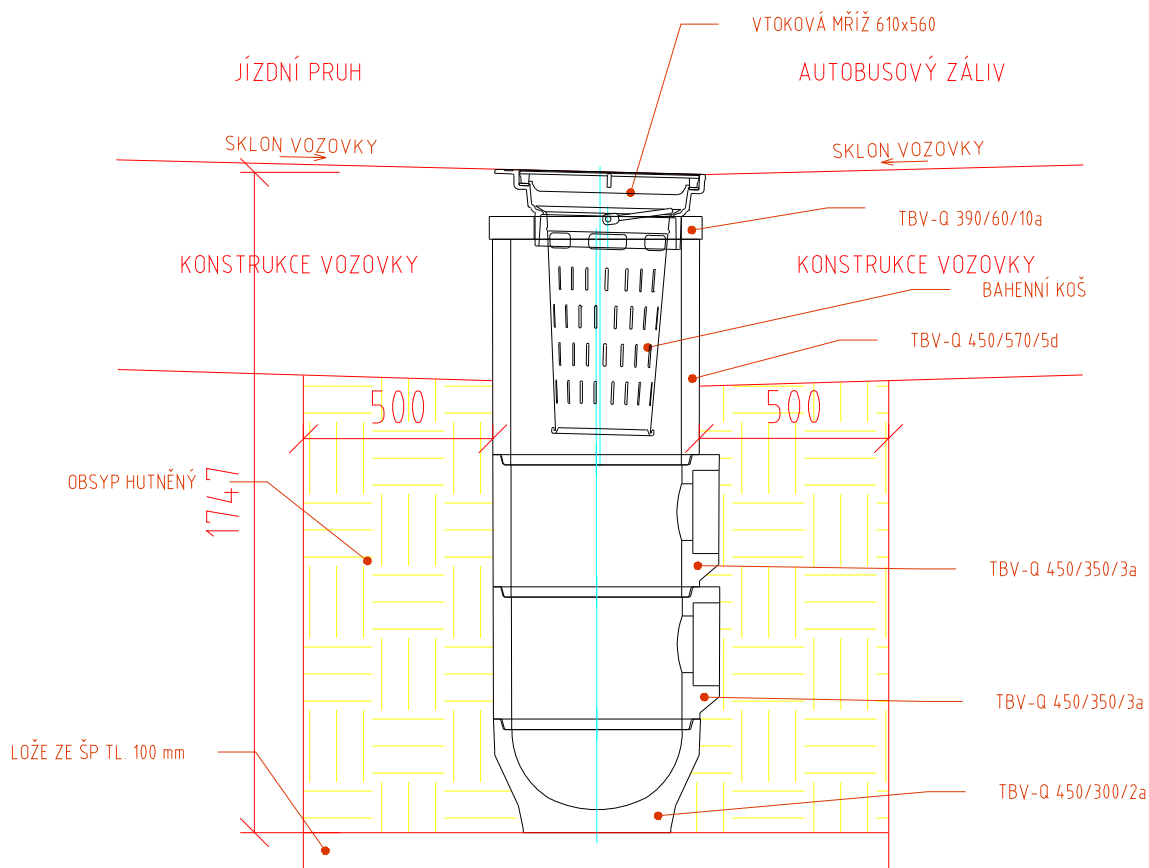

JEDNOTLIVÉ DÍLY SESTAVY

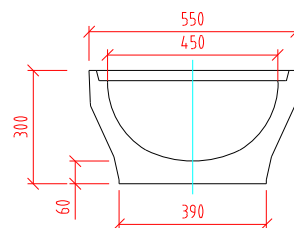
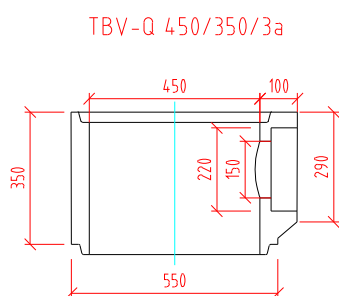
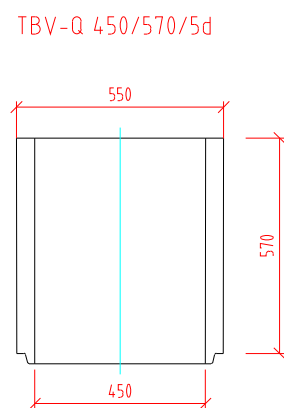
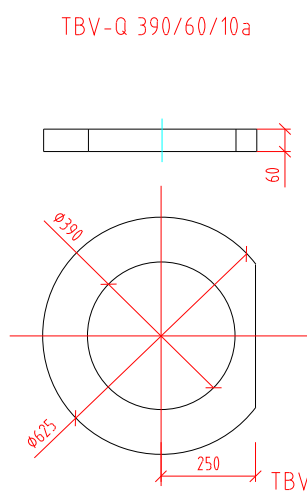
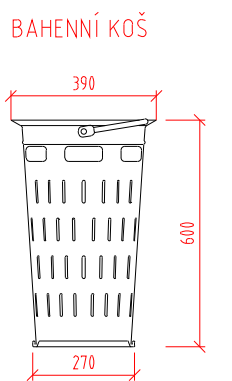
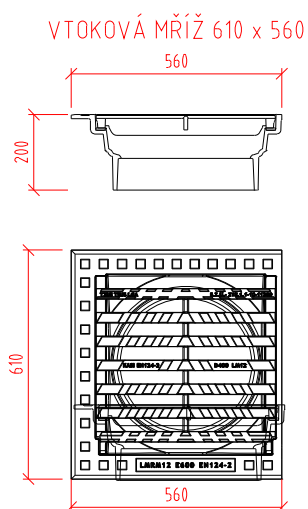

SKLADBA UV - ŠIKMÝ PRSTENEC - UV10, UV12, UV15, UV14, UV18, UV20

VTOKOVÁ MŘÍŽ V SAMONIVELAČNÍM RÁMU

1:20

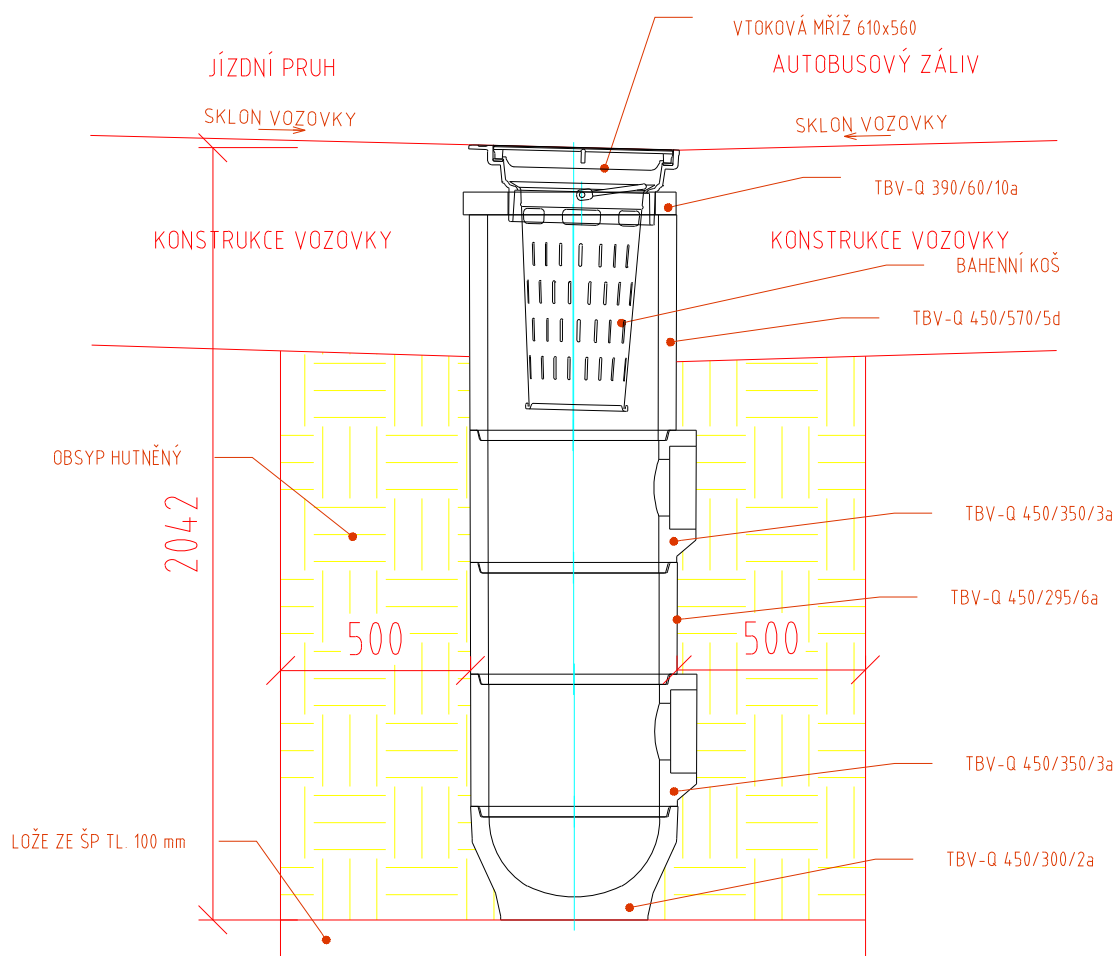

JEDNOTLIVÉ DÍLY SESTAVY

VTOKOVÁ MŘÍŽ 610 x 560

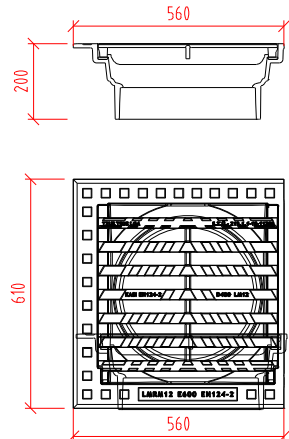

BAHENNÍ KOŠ

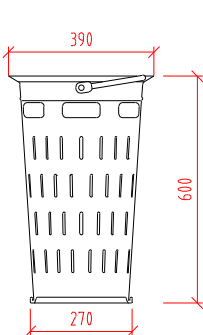

TBV-Q 390/60/10a

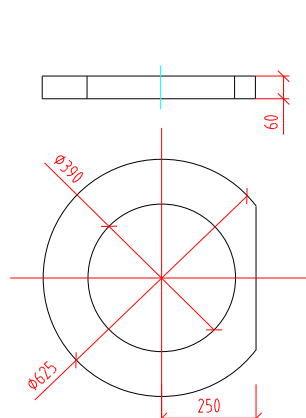

TBV-Q 450/570/5d

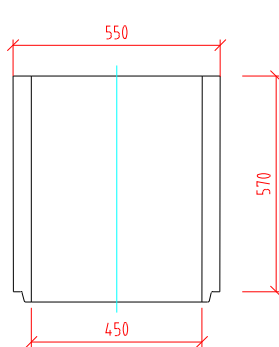

TBV-Q 450/295/6a

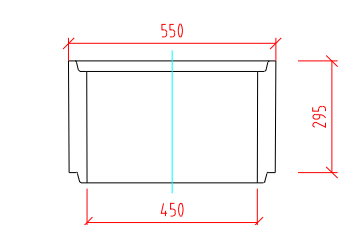

TBV-Q 450/350/3a

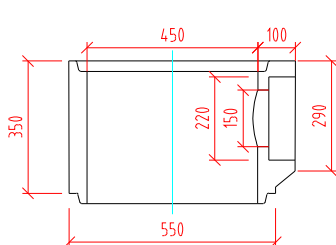

TBV-Q 450/300/2a

